

JUNEAU ALASKA



FOR YOUR NEXT MEETING...

TABLE OF CONTENTS

10 Ways JCVB Can Assist You	4
Juneau Fun Facts	4
Downtown & Valley Locator Maps	5
Centennial Hall Convention and Civic Center	6-7
Meeting Facility Grid	8-9
Meeting Space	10
Accommodations	11
Accommodations Grid	12
Catering	20
Transportation	20
Client Services	21
Extend Your Stay	22
What To Wear	23
Things To Do	23

WELCOME!

Alaska's capital city has welcomed visitors to these scenic coastal shores for many centuries.

From the early Tlingit people to the later day arrivals of gold seekers, fishermen, government workers and visitors, Juneau offers a long-standing tradition of hospitality.

Few destinations have the magnetism of Alaska.

- Its vast size boggles the mind (try to imagine 1/5 of the United States contained within one state's boundary line), not to mention the heart-pounding wildlife viewing, ancient Native cultures, scenic beauty that stirs your deepest senses, and air so clean your lungs just can't breathe enough.

Juneau can deliver all of what Alaska offers and then some.

- Spectacular surroundings...it has that.
- Small town charm and hospitality...it has that.
- A sense of safety and security...it has that.
- Professional meeting facilities and accommodations...it has that, too.
- Traffic congestion, long lines and urban angst...it doesn't have that.

Juneau may seem off the beaten "convention" pathway, yet we are very easy to get to.

- Juneau is closer to Seattle in flight time than it takes some people to commute to their cubicle...just 2 hours north as the eagle flies.
- Juneau is particularly well suited for small conventions (up to 600 people), board retreats, committee meetings, regional and divisional conferences.
- Centennial Hall convention and civic center is conveniently located within walking distance to hotels, restaurants and attractions.

The tired old convention trail may not be filling your delegates with the inspiration they want. The breathtaking spectacle of Alaska could offer the breath of fresh air they need.

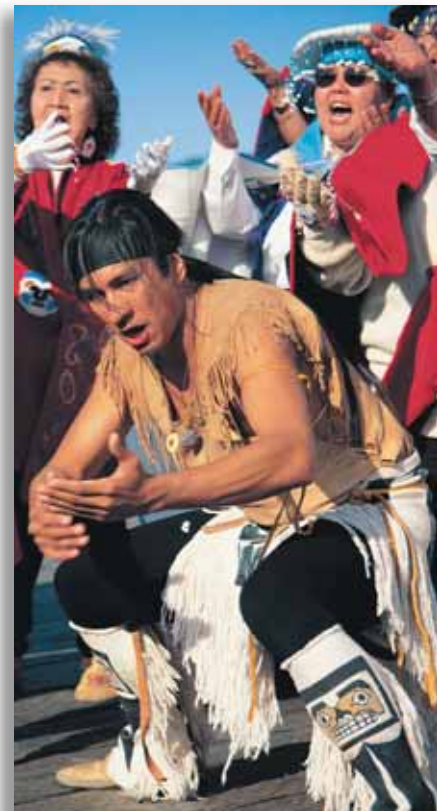

Meet us on the web at: traveljuneau.com/meetings

IT'S EASY TO GET HERE.

- Juneau is two hours by jet from Seattle and about an hour and 30 minutes from Anchorage.
- Juneau is served by Alaska Airlines year-round with an average of 18 flights per day from May to September and 9 flights per day from October through April.

Juneau ▶

Sample of Routes & Flight Times*

Chicago	5 hours
Dallas	5 hours
Denver	4.5 hours
Los Angeles	4.5 hours
Orlando	7 hours
San Francisco	3.5 hours
Seattle	2 hours
Washington D.C.	6.5 hours

* All flight times based on routes through Seattle, does not include layovers.

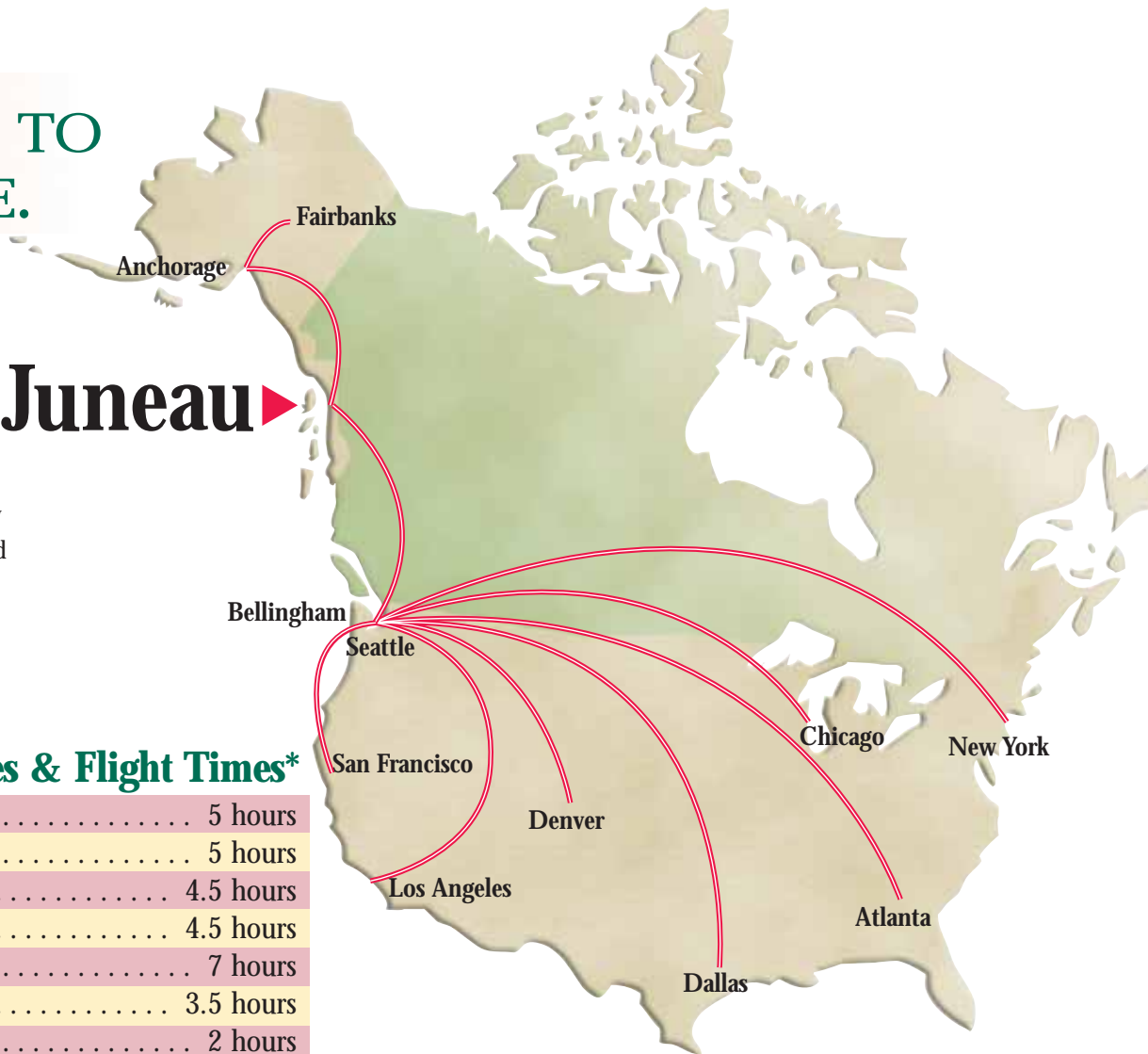

Time Zone

The State of Alaska is located in the Alaska Standard Time (AST) Zone, which is one hour behind Pacific Standard Time (PST) and four hours behind Eastern Standard Time (EST).

“The National Congress of American Indians conference in Juneau was the most successful Mid-Year Session in our 54 year history. With more than 800 attendees, the city of Juneau and its Convention and Visitors Bureau offered us invaluable help in finding housing, transportation, and meeting space. The personal attention we received from the JCVB was key to the success of the event.”

The National Congress of American Indians

JUNEAU FUN FACTS

- Juneau is the largest capital city in the US based on square miles.
- Juneau has just over 30,000 people and 20,000 bald eagles.
- Juneau has less than 200 miles of road, but more than 250 miles of hiking trails.
- Juneau has over 280 species of birds, three species of whales, all five species of salmon, black bear and the largest concentration of brown bear in the world.
- Enjoy the spectacular Aurora Borealis or “Northern Lights” October through May.
- Juneau is the only capital city that is solely accessible by marine vessel or aircraft. It is regularly serviced by the Alaska Marine Highway system, Alaska Airlines and several smaller commuter airlines.
- Juneau supports a symphony, an opera company, a lyric opera company, a professional theater company, a university and more.

10 WAYS JCVB CAN ASSIST YOU

With one call to the Juneau Convention & Visitors Bureau (800-587-2201), you can be on your way to a smooth and successful meeting!

- 1** Assist with group transportation and discounts by air, land, or sea!
- 2** Locate meeting space and offer venue ideas for your next meeting.
- 3** Supply collateral material, including brochures, maps, welcome signage and more.
- 4** Locate accommodations and check availability.
- 5** Arrange for site inspections of meeting space and lodgings.
- 6** Obtain special letters of welcome from local government officials and dignitaries.
- 7** Prepare welcome gift bags for your speakers and VIPs.
- 8** Help meeting attendees maximize their free time, including spousal programs and pre- and post-tours.
- 9** Market the destination to attendees via promotional materials.
- 10** Act as a liaison between the planner and the community. JCVB is aware of community events and other meetings which could have an impact on your event.



www.traveljuneau.com/meetings/help

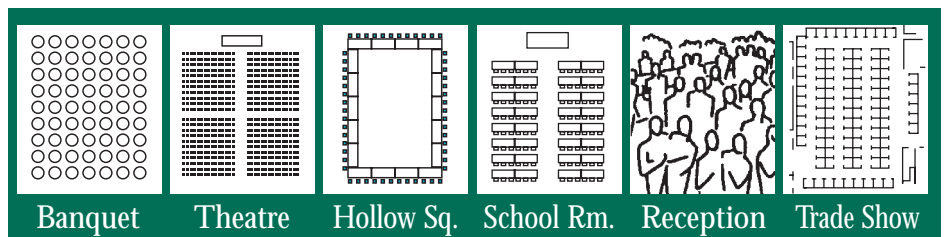

Need extra assistance? Ask for our Meeting Planners Help Guide.

Meet us on the web at: traveljuneau.com/meetings



HOTELS & ATTRACTIONS LOCATOR MAP

DOWNTOWN

- 1 Federal Building
- 2 Governor's House
- 3 Alaska State Capitol
- 4 City Museum
- 5 State Office Building
- 6 Alaska State Museum
- 7 Centennial Hall Conv. Center
- 8 City Hall
- 9 Juneau Public Library, Downtown Branch
- 10 Westmark Baranof Hotel
- 11 Prospector Hotel
- 12 Goldbelt Hotel
- 13 Driftwood Lodge
- 14 Breakwater Inn

VALLEY/AIRPORT

- 15 Juneau Airport Travelodge
- 16 Extended Stay Deluxe Juneau
- 17 Super 8 Motel

Walking Time to Convention Center Minute(s)

Alaska State Museum	1
Westmark Baranof Hotel	4
Prospector Hotel	2
Goldbelt Hotel	1
Driftwood Lodge	2
City Museum	6
Governor's House	10

Valley/Airport

- Visitor Information
- Parking
- Cruise Ship Docks
- Stairs
- Road
- Water



Downtown

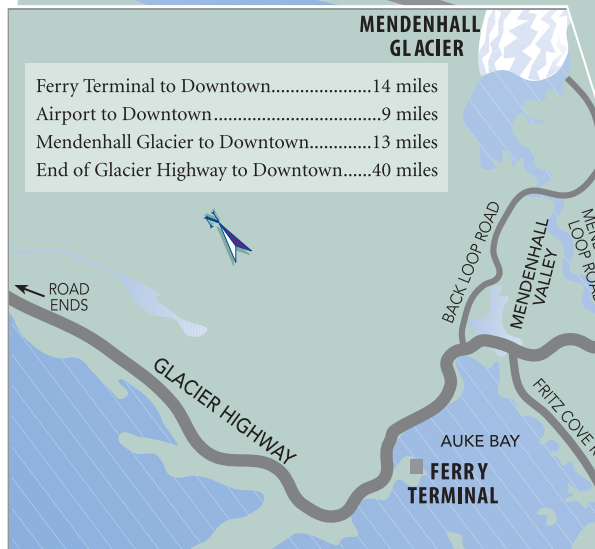
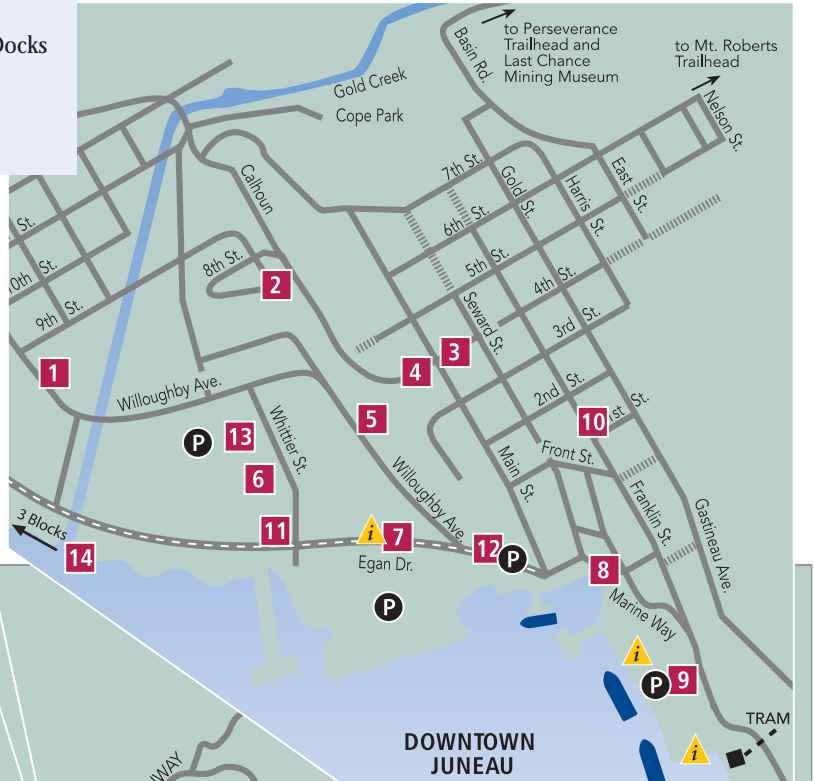

GETTING YOU CONNECTED

- Wide variety of presentation equipment available, including multi-media projectors, sound consoles, projection screens, microphones, laser pointers, easels, and more.
- Audio headsets for the hearing impaired. Clear-Com sets for show control systems.
- FREE high speed WiFi (wireless) Internet access throughout the facility. Hard-wired Internet access also available.
- 10 telephone lines available.
- 12' x 12' door in accessible ballroom for easy load-in. Loading dock available.
- Many trade show necessities included in booth price: pipe and drape, tablecloth, skirt, 72" x 30" table, and booth sizes 8' x 8' or 10' x 10'.
- Full service, commercial kitchen for in-house or professional catering options.
- Flexible ballroom can be divided into 1-3 rooms.
- Full service theatrical lighting packages available.
- Full service sound packages available.
- Full service special event decorating packages available.
- IMMEDIATE direct access to responsive Event Specialists via intra-facility radios.

CENTENNIAL HALL CONVENTION CENTER

With Centennial Hall's 20,000 square feet of meeting space, you can look forward to a successful meeting. Juneau's convention center is located next to the historic town center, hotels, restaurants, shops, art galleries, theaters, museums and entertainment. Centennial Hall's proximity to Alaska's state office building and historic state capitol building makes it ideal for government-related meetings.

All rooms feature state-of-the-art individual lighting and sound for professional presentations. A separate area designed for on-site registration, ticketing and event information is also available. Conventions, trade shows, small meetings, concerts and festivals are comfortably accommodated in Centennial Hall's versatile meeting, exhibit and performing spaces.

Catering services available offer everything from a simple coffee service to elegant gourmet banquets featuring local seafood cuisine and traditional favorites.

Call today for assistance in planning your next event in Southeast Alaska's premier meeting facility - (907) 586-5283.

*Centennial Hall Convention Center
101 Egan Drive
Juneau, AK 99801*



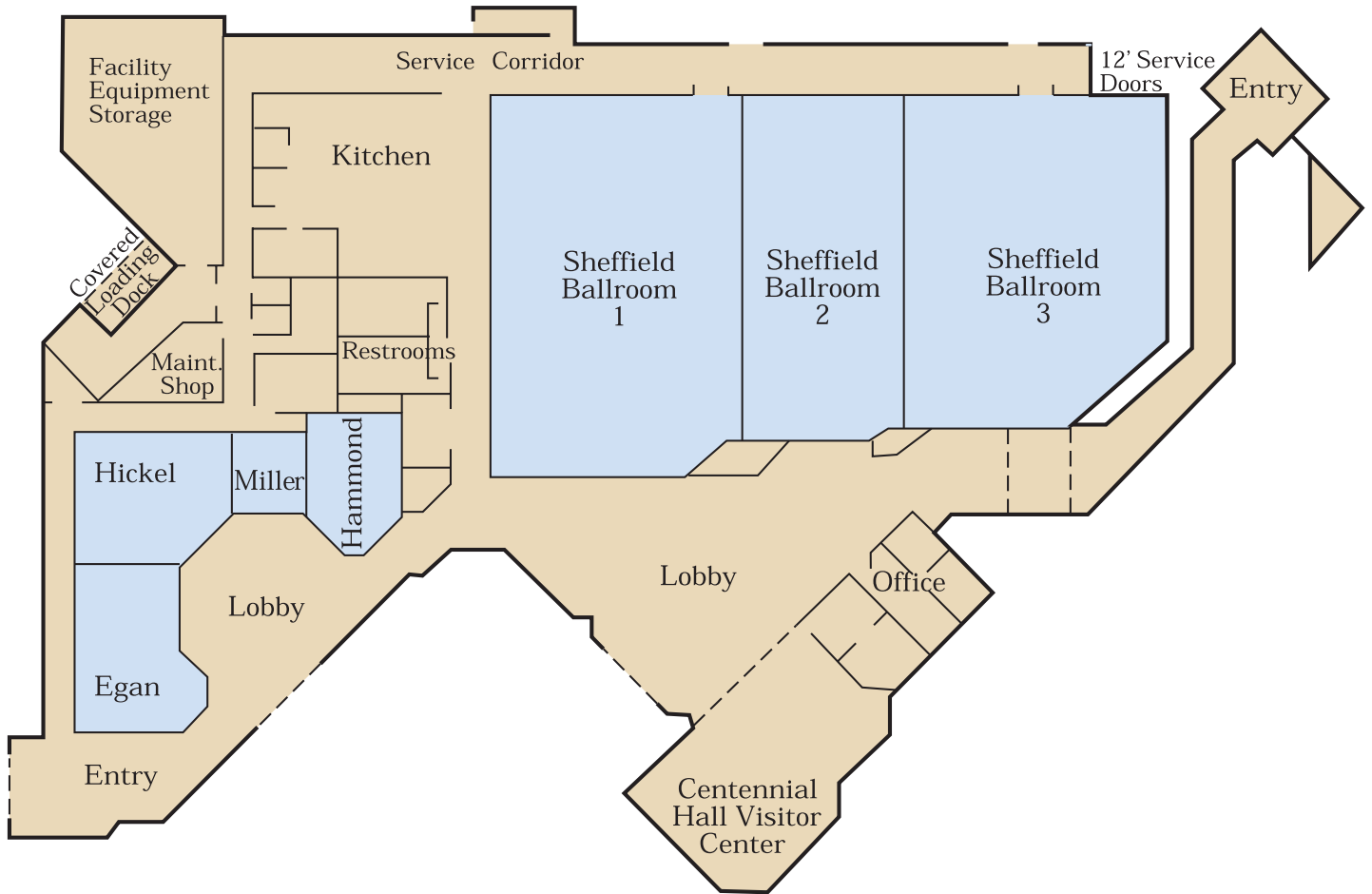

ROOM	LENGTH	WIDTH	AREA SQ. FT.	CEILING HEIGHT	LARGEST ENTRY	RECEPTION	BANQUET	CLASS RM.	THEATER	EXHIBIT 8'X10'
Entire Sheffield Ballroom	86	158	11,275	25	12x12	1,050	550	500	1200	81
Sheffield #1	86	50	4,140	25	7x8	390	200	175	350	36
Sheffield #2	79	40	3,065	25	7x8	285	150	130	220	19
Sheffield #3	72	59	4,070	25	12x12	375	230	180	350	24
Egan	40	25	1,100	10	3'3x7	122	80	50	75	7
Hickel Room	32	29	1,000	10	3'3x7	105	60	45	65	7
Hammond Room	32	23	670	10	3'3x7	65	50	38	40	5
Miller Room	18	16	290	10	3'3x7	65	10	15	18	1
Ballroom Lobby	90	50	2,800	10	3x8	300				
Meeting Room Lobby	40	40	1,400	10	3x8	125				

Capacity contingent on room layout.

WE CAN HELP

Juneau is full of unique meeting venues. If you don't see what you're looking for, call our Convention Services Department for additional ideas. 1-800-587-2201

MEETING FACILITIES QUICK REFERENCE GRID

Facility	Capacity					Location
	Reception	Banquet	Class	Theater	Sq. Ft.	
Adlersheim Wilderness Lodge	75	50	50	50	810	33 Miles from Downtown
Alaska Native Brotherhood Hall	840	404	404	500	6156	Downtown
Room 1	100	70	50	100	990	
Room 2	125	100	65	125	1290	
Room 3	400	280	210	415	3876	
Breakwater Inn	24	21	16	18	220	Downtown
Centennial Hall Convention & Civic Center	See Page 7					Downtown
Eaglecrest Ski Area	150+	150+	150+	150+		Douglas
Extended Stay Deluxe Juneau Ray Renshaw Room	100	80	80	100	1100	Valley
Four Seasons Tours/Orca Point Lodge						Colt Island
Lodge Capacity	250	250	250	250		
Boat Capacity	150+	150+	150+	150+		
Glacier Gardens Rainforest Adventure	200	150	n/a	n/a	6912	Valley
Goldbelt Hotel Juneau						Downtown
Conference Suite	100	56	30	40	780	
Tongass Suite	25-50	18	25	30	621	
Admiralty Suite	25-50	18	20	25	728	
Hangar on the Wharf Ballroom	150	72	100	100	900	Downtown
Juneau Douglas City Museum	285	20	20-30	20-30	2500	Downtown
Juneau International Airport Aurora Room	120	90	90	100	1200	Valley
Juneau Super 8 Motel Conference Room	35	20	30	35	300	Valley
Juneau Travelodge Hotel						Valley
Glacier Room	100	100	60	150	1400	
Sarape Room (In Restaurant)	30	30	10	20	432	
Eagle Room	35	30	25	25	540	
Macaulay Salmon Hatchery	100	75	50	100	2400	Salmon Creek
Mount Roberts Tramway						Downtown
Lower Terminal	60	n/a	30	n/a	750	
Timberline Bar & Grill	235	200	80	n/a	3510	
Chilkat Theater	n/a	n/a	120	120	2700	
The Nature Center	n/a	30	25	16	625	
Pearson's Pond Luxury Inn and Adventure Spa	24	12	16	16	600	Valley



MEETING FACILITIES Continued

QUICK REFERENCE GRID

Facility	Capacity					Location
	Reception	Banquet	Class	Theater	Sq. Ft.	
Prospector Hotel						Downtown
Douglas Room	65	45	40	75	1173	
Gastineau Room	30	21	21	35	525	
The Shrine of St. Therese						23 Miles from Downtown
Chapel	n/a	n/a	95	95		
The Lodge	50	38	35	40	725	
LeVasseur Cabin	20	NA	10	10	320	
Hermitage "Gap" Cabin	15	10	10	12	221	
Little Flower Retreat	25	15	15	20	225	
Jubilee Cabin	35	25	25	30	450	
Silverbow Inn, Bakery & The Back Room Theater	100	55	30	85	800	Downtown
Westmark Baranof Hotel						Downtown
Treadwell Room	300	160	112	220	2068	
Douglas Room	80	40	40	70	704	
A.J. Room	70	30	24	50	672	
Gastineau Suite	80	40	40	70	882	
Iris Room	25	12	12	20	300	
Nugget Room	25	18	12	20	300	
Suite 307	25	12	12	20	300	
Suite 207	25	12	12	20	300	



MEETING SPACE DIRECTORY

Adlersheim Wilderness Lodge

PO Box 35544
Juneau, AK 99803
tel. (907) 723-8245
fax (907) 789-5856
naomi@yankeecove.com
www.yankeecove.com

Alaska Native Brotherhood Camp #2

320 W Willoughby Avenue, Ste 100
Juneau, AK 99801
tel. (907) 586-2049
fax (907) 586-3301
anbjnu2@ak.net

Breakwater Inn

1711 Glacier Avenue
Juneau, AK 99801
toll free: (888) 586-6303
tel. (907) 586-6303
fax (907) 463-4820
breakwaterinn@gci.net
www.breakwaterinn.com

Centennial Hall Convention Center

101 Egan Drive
Juneau, AK 99801
tel. (907) 586-5283
fax (907) 586-1135
centennial_hall@mail.ci.juneau.ak.us
www.juneau.org/centennial

Eaglecrest Ski Area

155 S Seward Street
Juneau, AK 99801
tel. (907) 586-5284
fax (907) 586-5677
ecrestak@alaska.net
www.skijuneau.com

Extended Stay Deluxe Juneau

1800 Shell Simmons Drive
Juneau, AK 99801
toll free (800) 398-7829
tel. (907) 790-6435
fax (907) 790-6621
jss@extendedstay.com
www.extendedstay.com

Four Seasons Tours/Orcas Point Lodge

Group Sales Office:
(360) 779-8687
fax (360) 779-4833
info@4seasonsmarine.com
www.4seasonsmarine.com

Glacier Gardens Rainforest Adventure

7600 Glacier Highway
Juneau, AK 99801
tel. (907) 790-3377
fax (907) 790-3907
ggardens@ptialaska.net
www.glaciargardens.com

Glacier Restaurant, Lounge & Catering

1873 Shell Simmons Drive, Ste 220
Juneau, AK 99801
907-790-3055
fax (907) 789-3090
elaglacier@aol.com

Goldbelt Hotel Juneau

51 Egan Drive
Juneau, AK 99801
toll free : (888) 478-6909
tel. (907) 586-6900
fax (907) 463-3567
mail.GHJ@goldbelt.com
www.GoldbeltHotel.com

Hangar on the Wharf

#2 Marine Way, Ste 106
Juneau, AK 99801
tel. (907) 586-5018
fax (907) 586-8173
www.hangaronthewharf.com

Juneau Super 8 Motel

2295 Trout Street
Juneau, AK 99801
toll free: (800) 800-8000
tel. (907) 789-4858
fax (907) 789-5819
juneauS8@pendeserv.com
www.super8.com

Juneau Travelodge Hotel

9200 Glacier Highway
Juneau, AK 99801
toll free: (888) 660-2327
tel. (907) 789-9700
fax (907) 789-1969
gmtravelodge@gci.net
www.travelodge.com

Macaulay Salmon Hatchery

2697 Channel Drive
Juneau, AK 99801
toll free: (877) 463-2486
tel. (907) 463-4810
fax (907) 463-5614
Emily_Souza@dipac.net
www.dipac.net

Mount Roberts Tramway

3075 Vintage Boulevard
Juneau, AK 99801
toll free: (888) 461-8726
tel. (907) 463-3412
fax (907) 463-5095
mail.MRT@goldbelt.com
www.MountRobertsTramway.com

Pearson's Pond Luxury Inn and Adventure Spa

4541 Sawa Circle
Juneau, AK 99801
toll free (888) 658-6328
tel. (907) 789-3772
fax (907) 790-1965
book@pearsonspnd.com
www.pearsonspnd.com

Prospector Hotel

375 Whitter Street
Juneau, AK 99801
toll free: (800) 331-2711
tel. (907) 586-3737
fax (907) 586-1204
prospect@ptialaska.net
www.prospectorhotel.com

The Shrine of St. Therese

5933 Lund Street
Juneau, AK 99801
tel. (907) 780-6112
fitterer@gci.net
www.shrineofsainttherese.org

Silverbow Inn, Bakery and Catering

120 Second Street
Juneau, AK 99801
toll free: (800) 586-4146
tel. (907) 586-4146
fax (907) 586-4242
info@silverbowinn.com
www.silverbowinn.com

Westmark Baranof Hotel

127 N Franklin Street
Juneau, AK 99801
toll free: (800) 764-0017
tel. (907) 463-6208
fax (907) 463-5424
wmbnf-gm@hollandamerica.com



ACCOMMODATIONS DIRECTORY

HOTELS, B&B'S, INNS AND LODGES

Adlersheim Wilderness Lodge

PO Box 35544
Juneau, AK 99803
tel. (907) 723-8245
fax (907) 789-5856
naomi@yankeecove.com
www.yankeecove.com

Breakwater Inn

1711 Glacier Avenue
Juneau, AK 99801
toll free: (888) 586-6303
tel. (907) 586-6303
fax (907) 463-4820
breakwaterinn@gci.net
www.breakwaterinn.com

Driftwood Lodge

435 Willoughby Avenue
Juneau, AK 99801
toll free (800) 544-2239
tel. (907) 586-2280
fax (907) 586-1034
driftwood@gci.net
www.driftwoodalaska.com

Extended Stay Deluxe Juneau

1800 Shell Simmons Drive
Juneau, AK 99801
toll free (800) 398-7829
tel. (907) 790-6435
fax (907) 790-6621
jss@extendedstay.com
www.extendedstay.com

Goldbelt Hotel Juneau

51 Egan Drive
Juneau, AK 99801
toll free : (888) 478-6909
tel. (907) 586-6900
fax (907) 463-3567
mail.GHJ@goldbelt.com
www.GoldbeltHotel.com

Juneau Super 8 Motel

2295 Trout Street
Juneau, AK 99801
toll free: (800) 800-8000
tel. (907) 789-4858
fax (907) 789-5819
juneauS8@pendevserv.com
www.super8.com

Juneau Travelodge Hotel

9200 Glacier Highway
Juneau, AK 99801
toll free: (888) 660-2327
tel. (907) 789-9700
fax (907) 789-1969
gmtravelodge@gci.net
www.travelodge.com

Pearson's Pond Luxury Inn and Adventure Spa

4541 Sawa Circle
Juneau, AK 99801
toll free (888) 658-6328
tel. (907) 789-3772
fax (907) 790-1965
book@pearsonspod.com
www.pearsonspod.com

Prospector Hotel

375 Whitter Street
Juneau, AK 99801
toll free: (800) 331-2711
tel. (907) 586-3737
fax (907) 586-1204
prospect@ptialaska.net
www.prospectorhotel.com

The Shrine of St. Therese

5933 Lund Street
Juneau, AK 99801
tel. (907) 780-6112
fitterer@gci.net
www.shrineofsainttherese.org

Silverbow Inn, Bakery and Catering

120 Second Street
Juneau, AK 99801
toll free: (800) 586-4146
tel. (907) 586-4146
fax (907) 586-4242
info@silverbowinn.com
www.silverbowinn.com

Westmark Baranof Hotel

127 N Franklin Street
Juneau, AK 99801
toll free: (800) 764-0017
tel. (907) 463-6208
fax (907) 463-5424
wmbnf-gm@hollandamerica.com

ACCOMMODATIONS QUICK REFERENCE GRID

ACCOMMODATIONS

ACCOMMODATIONS	Sleeping Rooms	Suites	Meeting Rooms	Airport shuttle	Internet Access	Full Service Restaurant	Workout Facility
Adlersheim Wilderness Lodge	5	3	1	no	yes	no	no
Breakwater Inn	49	0	1	yes	yes	yes	no
Driftwood Lodge	62	32	0	yes	yes	yes	no
Extended Stay Deluxe Juneau	95	93	1	yes	yes	no	yes
Goldbelt Hotel	106	1	3	yes	yes	yes	no
Juneau Super 8 Motel	75	3	1	yes	yes	no	no
Juneau Travelodge Hotel	86	0	3	yes	yes	yes	yes
Pearson's Pond Luxury Inn & Adventure Spa	5	2	1	no	yes	no	yes
Prospector Hotel	61	7	2	no	yes	yes	no
The Shrine of St. Therese	16	n/a	2	no	no	no	no
Silverbow Inn	11	0	1	no	yes	yes	no
Westmark Baranof Hotel	195	35	7	no	yes	yes	yes



WESTMARK BARANOF



The historic Westmark Baranof has reigned for many years as the “Grand Dame” of Alaska’s state capital. Built to rival the most lavish hotels of its day, this historic boutique hotel has served as a second home for business travelers and state legislators for many years. Located downtown within walking distance of the state capitol, government offices, shopping and Centennial Hall Convention Center, the nine-story hotel is known for its elegance, comfortable accommodations and courteous, attentive staff.

Juneau’s only convention hotel features 195 guest rooms, 8 meeting rooms (totaling over 5500 sq. ft.), café, fine-dining restaurant and lounge, as well as professional sales and catering departments.

The recently remodeled Westmark Baranof Hotel is FEMA approved with hard-wired smoke detectors and sprinkler systems in all guest rooms and public areas.



127 N. Franklin Street • toll free: (800) 764-0017 • tel: (907) 586-6208 • fax: (907) 463-5424 • 195 rooms & suites

ROOM NAME	DIMENSIONS	SQUARE FT.	BANQUET	RECEPTION	CLASS/CONF	THEATRE
TREADWELL ROOM	44 X 47	2068	160	300	112/65	220
DOUGLAS ROOM	44 X 16	704	40	80	40/30	70
AJ ROOM	32 X 21	672	30	70	24/25	50
GASTINEAU SUITE	42 X 21	882	40	80	40/30	70
IRIS ROOM	15 X 20	300	12	25	12/12	20
NUGGET ROOM	15 X 20	300	18	25	12/12	20
SUITE 307	15 X 20	300	12	25	12/12	20
SUITE 207	15X20	300	12	25	12/12	20

JUNEAU TRAVELODGE HOTEL



The Travelodge Hotel is conveniently located across from the Juneau International Airport in the Mendenhall Valley near the Mendenhall Glacier and the Alaska Marine Highway Ferry Terminal, and just minutes away from an Alaskan adventure. Surrounded by majestic mountains and pristine wilderness our breathtaking views, oversized guest rooms, great customer service and convenient airport location will make your stay comfortable. What else could you ask for in a hotel?

- Oversized two queen bed, single king, and queen rooms.
- 24 hour airport/ferry shuttle
- Free continental breakfast
- Free wireless Internet in rooms, common areas and restaurant
- In room coffee maker, hairdryer, iron and full sized board
- Microwaves and mini refrigerator
- Indoor heated pool
- Exercise room
- 3 banquet rooms
- Interior corridors
- In-room safes
- Mi Casa Mexican-American Restaurant
- Travel Lodge Sports Lounge



9200 Glacier Highway • Juneau, AK 99801 • toll free: (800) 578-7878
tel: (907) 789-9700 • fax (907) 789-1969 • www.travelodge.com
sbowman@alaska.com

ROOM NAME	DIMENSIONS	SQUARE FT.	BANQUET	RECEPTION	CLASS/CONF	THEATRE
GLACIER ROOM	40 X 35	1400	100	150	60	100
SARAPE ROOM	24 X 18	432	30	30	10	20
EAGLE ROOM	24 X 18	432	30	35	25	25

PROSPECTOR HOTEL



Conveniently located across the street from Centennial Hall Convention & Civic Center and the State office building, adjacent to the Alaska State Museum and within easy walking distance to the heart of downtown

- 62 spacious rooms each includes cherry wood hospitably unit with microwave, refrigerator and coffee maker featuring locally roasted gourmet Heritage Coffee
- In-room hairdryer, iron and ironing board, high speed internet access, direct dial phone and *free* local calls
- Each room also features 50+ premium cable TV channels with HBO
- Beautiful full-service dining room and T.K. Maguire's lounge
- Famous Alaskan seafood dishes and the best prime rib in Juneau, as well as the most experienced local catering staff
- Wireless internet

Make the Prospector Hotel your choice for genuine Alaskan hospitality



375 Whittier Avenue • Juneau, AK 99801 • toll free: (800) 331-2711 • In State (800) 478-5866
tel: (907) 586-3737 • fax (907) 586-1204 • www.prospectorhotel.com • prospect@ptialaska.net

ROOM NAME	DIMENSIONS	SQUARE FT.	BANQUET	RECEPTION	CLASS/CONF	THEATRE
DOUGLAS ROOM	51 X 21	1173	50	60	45	75
GASTINEAU ROOM	21 X 25	525	30	21	21	35

GOLDBELT HOTEL JUNEAU



Juneau's Premier Hotel invites delegates to enjoy true Southeast Alaskan hospitality.

With a commanding view of Gastineau Channel, our 105 room hotel offers full service accommodations, dining and meeting facilities and is conveniently located across from the waterfront, it's next door to Centennial Hall Convention Center and within walking distance of downtown shops and restaurants.

When the success of your convention depends on convenient location, the right facility and attention to detail, the Goldbelt Hotel is the one to call. All rooms include hair dryers, ironing boards and coffee makers, with exercise equipment in many rooms. We also offer valuable airline mileage!

Whether your meeting or convention is for 2 or 200, we cater to your needs before, during and after your meeting. By combining Centennial Hall's meeting space with guest rooms at the Goldbelt Hotel Juneau, large groups can be accommodated with a single toll-free call.



51 Egan Drive • Juneau, AK 99801 • tel: (907) 586-6900
 • Hotel reservations (888) 478-6909 • fax (907) 463-3567
www.GoldbeltHotel.com • mail.GHJ@goldbelt.com

ROOM NAME	DIMENSIONS	SQUARE FT.	BANQUET	RECEPTION	CLASS/CONF	THEATRE
CONFERENCE ROOM	30 X 26	780	100	56	30	40
TONGASS ROOM	23 X 27	621	16	50	25	30
ADMIRALTY SUITE	27 X 26	728	18	50	20	25

MOUNT ROBERTS TRAMWAY

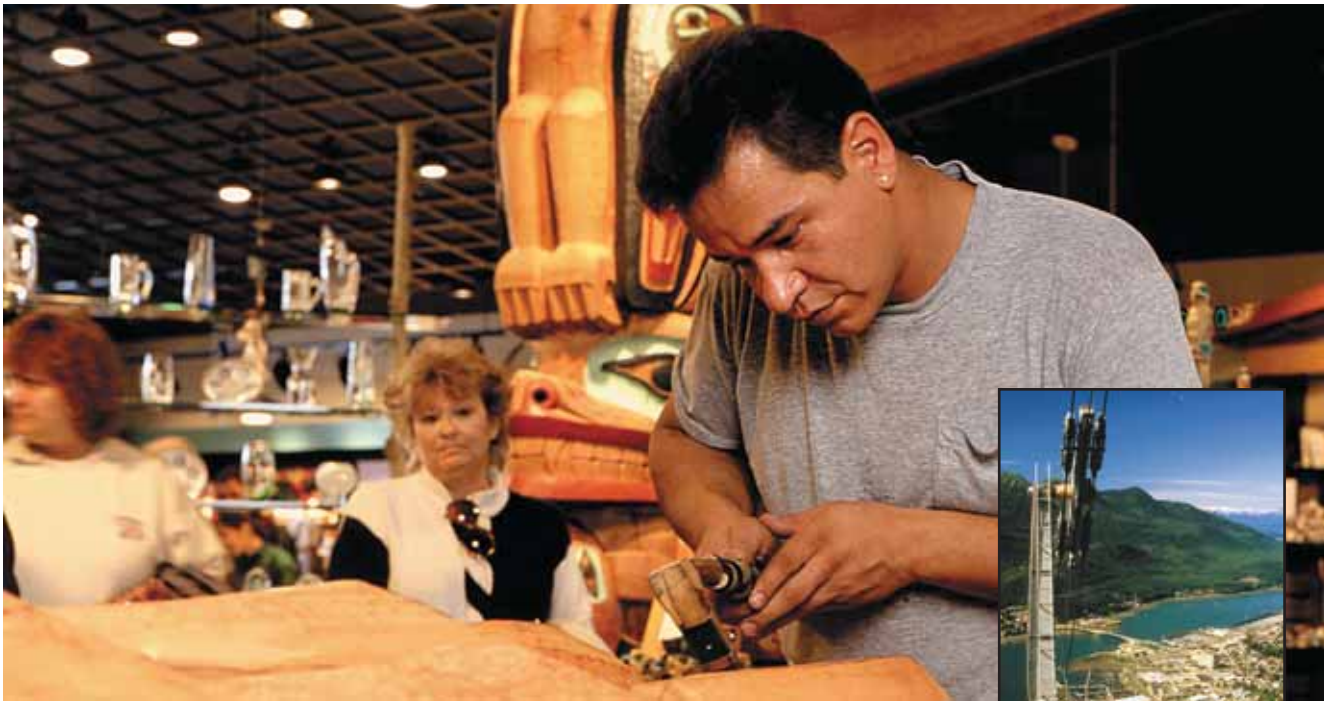

SEE IT ALL. DO IT ALL.
ABOVE IT ALL.

Experience a scenic adventure aboard the Mount Roberts Tramway and offer your convention delegates a one-of-a-kind adventure.

The adventure begins within walking distance from the Goldbelt & Westmark Baranof Hotels. You'll board a tramcar adorned in Tlingit artwork and ride through the exhilarating Southeast Alaska rainforest 1800 feet up Mount Roberts.

At the top, enjoy the amenities of the Mountain Station. The Station houses the Chilkat Theater, Mountain Top Gifts, and the Timberline Restaurant, perfect for meetings, receptions, banquets, casual or formal, large or small. An introduction to the Tlingit culture can be experienced as a live dance performance or by viewing the award winning film *Seeing Daylight*, in the Chilkat Theater.

Let our Meeting Coordinator plan your entire event from lodging, group discounts & tour packages to a wide variety of meeting, convention, banquet, & reception services.



GOLDBELT
MOUNT ROBERTS
TRAMWAY

490 South Franklin • Juneau, AK 99801 • tel: (907) 463-3412

fax (907) 463-5095 • mail.MRT@goldbelt.com

www.MountRobertsTramway.com

ROOM NAME	DIMENSIONS	SQUARE FT.	BANQUET	RECEPTION	CLASS/CONF	THEATRE
LOWER TERMINAL			80	150	80	80
UPPER TERMINAL						
TIMBERLINE REST.	78 X 45	3510	200	250	80	80
CHILKAT THEATER	60 X 45	2700			120	120
NATURE CENTER	25 X 25	625		30	25	16

Contact the Juneau Meeting Help Line at 1-800-587-2201

GLACIER GARDENS, RAINFOREST ADVENTURE

Glacier Gardens invites you to tour 50 acres of beautiful gardens & rainforest on a guided adventure taking you to spectacular scenic overlooks on Thunder Mountain. Your guests will be in awe when you book your next private reception or party inside Glacier Gardens' atrium. Open seasonally, May – Sept. Garden & Rainforest tours 9 a.m. – 6 p.m. daily, receptions 6 p.m. – 8 p.m.



Glacier Gardens
RAINFOREST ADVENTURE

7600 Glacier Highway • Juneau, AK 99801
tel: 907-790-3377 • fax: 907-789-5598
www.glaciorgardens.com • ggardens@ptialaska.net

FOUR SEASONS TOURS & ORCA POINT LODGE

Experience quiet wilderness within minutes of downtown Juneau! Whether you're planning a meeting, retreat, or a fun group activity; our crew will show you why Orca Point Lodge is a popular destination for incentive & business groups. Customized whale watching tours & social events to fit your schedule and needs. Buffet style meal service featuring fresh grilled Alaska salmon.



tel: 360-779-8687
fax 360-779-4833
www.4seasonsmarine.com
info@4seasonsmarine.com

MACAULAY HATCHERY



Juneau's scenic Macaulay Salmon Hatchery and Visitor's Center is located just 3 miles from downtown Juneau. This awe inspiring facility is an ideal setting for meetings, receptions and conferences. Beautiful aquariums and exhibits that can be seen year 'round, create a spacious, tranquil and educational environment inside, while the large deck outside provides inspiring views of Gastineau Channel. All the necessary amenities are available to make your event a success.



2697 Channel Drive
Juneau, AK 99801
toll free 877-463-2486
tel: (907) 463-4810
fax: (907) 463-5614
www.dipac.net
Emily_Souza@dipac.net

ROOM NAME	DIMENSIONS	SQUARE FT.	BANQUET	RECEPTION	CLASS/CONF	THEATRE
VISITOR'S CENTER		2400	50	250	50	100

GLACIER RESTAURANT & CATERING



Best meeting & catering facility in the Valley, located inside the Juneau International Airport. Let the experts do the work for you and pleasantly fulfill your needs.

A division of ESS Support Services Worldwide



Glacier Restaurant & Catering

1873 Shell Simmons Drive
Suite 220
Juneau, AK 99801
tel: 907-790-3055
fax 907-789-3090
Email elaglacier@aol.com

*Call for additional meeting options

MEETING ROOM	DIMENSIONS	SQUARE FT.	BANQUET	RECEPTION	CLASS/CONF	THEATRE
AURORA ROOM	40 X 30	1200	90	120	90	100

ADLERSHEIM WILDERNESS LODGE

Welcome to our paradise! Whether it's for work or play you will treasure every moment you get to spend at Adlersheim (odd'-lers-hime) Wilderness Lodge. We are only 33 miles from downtown Juneau. The lodge is nestled on 9 acres of beach front property with a private dock. The first class accommodations and wireless internet are sure to please any crowd.



33.3 Mile Glacier Highway • PO Box 35544
Juneau, AK 99803 • Toll Free: (888) 874-6227
Phone: (907) 723-8245 • Fax: (907) 789-5856
naomi@yankeecove.com • www.yankeecove.com

CHAMBERS MANAGEMENT

Let your association leaders shine. Our programs fit your budget and deliver only the services you want, freeing you to focus on your meaningful mission. Headquartered in Juneau, Chambers Management specializes in statewide conferences and trade shows from 12 to 500 attendees. We have years of success bringing people together in Alaska and welcome your members to Juneau.

- online credit card registration
- marketing & publicity
- logistic coordination
- sponsor/exhibitor booths
- local event staff
- presenter/speaker relations
- hotel & catering contract negotiation
- wrap-up accounting & reporting



www.chambersmanagement.com

CATERING DIRECTORY

Breakwater Inn

1711 Glacier Avenue
Juneau, AK 99801
toll free: (888) 586-6303
tel. (907) 586-6303
fax (907) 463-4820
breakwaterinn@gci.net
www.breakwaterinn.com

DocWater's Pub

#2 Marine Way, Ste 125
Juneau, AK 99801
tel. (907) 586-3627
fax (866) 669-1713
info@DocWatersPub.com
www.DocWatersPub.com

Glacier Restaurant, Lounge & Catering

1873 Shell Simmons Drive, Ste 220
Juneau, AK 99801
907-790-3055
fax (907) 789-3090
elaglacier@aol.com

Hangar on the Wharf

#2 Marine Way, Ste 106
Juneau, AK 99801
tel. (907) 586-5018
fax (907) 586-8173
www.hangaronthewharf.com

Prospector Hotel

375 Whitter Street
Juneau, AK 99801
toll free: (800) 331-2711
tel. (907) 586-3737
fax (907) 586-1204
prospect@ptialaska.net
www.prospectorhotel.com

Silverbow Inn, Bakery and Catering

120 Second Street
Juneau, AK 99801
toll free: (800) 586-4146
tel. (907) 586-4146
fax (907) 586-4242
info@silverbowinn.com
www.silverbowinn.com

Westmark Baranof Hotel

127 N Franklin Street
Juneau, AK 99801
toll free: (800) 764-0017
tel. (907) 463-6208
fax (907) 463-5424
wmbnf-gm@hollandamerica.com

Zen Restaurant

51 Egan Drive
Juneau, AK 99801
tel. (907) 586-5075
fax (907) 586-5076
zenrestaurant@aol.com
www.zen-restaurant.net

TRANSPORTATION DIRECTORY

Alaska Airlines

Group Desk
toll free: (800) 445-4435
General Information and Reservations
toll free: (800) 252-7522
www.alaskaair.com

Cruise West

2301 Fifth Ave., Ste. 401
Seattle, WA 98121
tel. (206) 441-8687
fax (206) 441-4757
louanns@cruisewest.com
www.cruisewest.com

EverGreen Taxi

PO Box 33766
Juneau, AK 99803
tel. (907) 586-2121
fax (907) 780-7856
res@evergreentaxi.com
www.evergreentaxi.com

Gray Line of Alaska/Holland America Line

3241 Hospital Drive
Juneau, AK 99801
tel. (907) 586-9625
fax (907) 586-5886
chagan2@hollandamerica.com
www.graylineofalaska.com

Princess Tours

151 Mill Street
Juneau, AK 99801
tel. (907) 463-3900
fax (907) 463-5055
juneautours@princesstours.com

COVER PHOTOS Top: © AK Div. of Community/Business Development; © JCVB/John Hyde; Bottom: photo courtesy ATIA
PAGE 2: Bottom right: © Todd Antioquia
PAGE 6: Bottom left: © Mark Wayne, Alaska Div. of Tourism
PAGE 11: © JCVB/John Hyde
PAGE 12: © JCVB/Paul Laramée
PAGE 21: © JCVB/John Hyde
PAGE 22: © David McMaster



CLIENT SERVICES DIRECTORY

PLANNING ASSISTANCE

Chambers Management

4382 Taku Boulevard
Juneau, AK 99801
tel. (907) 209-4382
fax (907) 463-4279
sara@chambersmanagement.com
www.chambersmanagement.com

The Coordinators Inc.

329 F Street, Ste 208
Anchorage, AK 99501
tel. (907) 646-6900
fax (907) 646-9001
info@thecoordinatorsinc.com
www.thecoordinatorsinc.com

Creativation Event Planning

4335 Manor Avenue
Juneau, AK 99801
tel. (907) 321-3094
fax (907) 790-3949
creativation@ak.net
www.mycreativation.com

Gaiptman Communications

PO Box 20385
Juneau, AK 99802
tel. (907) 586-1503
gaiptman.communications@gmail.com

Juneau Convention & Visitors Bureau

One Sealaska Plaza, Ste 305
Juneau, AK 99801
toll free: (800) 587-2201
tel. (907) 586-1737
fax (907) 586-1449
meetinginfo@traveljuneau.com
www.traveljuneau.com

Logistics, LLC

520 E 3rd Avenue
Anchorage, AK 99501
tel. (907) 276-6060
fax (907) 276-6061
toni@logisticsllc.com
www.logisticsllc.com

Visions Meeting & Event Management

999 E Tudor Road, Ste 200
Anchorage, AK 99503
tel. (907) 786-0141
fax (907) 562-2016
karen.zak@visionsus.com
www.visionsus.com

PRINTING/COPYING

Alaska Litho

101 Mill Street
Juneau, AK 99801
tel. (907) 586-3170
fax (907) 463-4924
travis@aklitho.com
www.aklitho.com

Copy Express

230 Seward Street
Juneau, AK 99801
tel. (907) 586-2174
fax (907) 463-3083
ken@copy-express.com
www.copy-express.com

Printing Trade Company

10002 Crazy Horse Drive
Juneau, AK 99801
tel. (907) 789-7636
fax (907) 789-9472
ptc@alaska.com

MEDIA

KJNO/Taku 105

3161 Channel Drive, Ste 2
Juneau, AK 99801
tel. (907) 586-3630
fax (907) 463-3685
nancy@taku105.com
www.taku105.com

KTOO FM & TV

360 Egan Drive
Juneau, AK 99801
toll free: (800) 870-5866
tel. (907) 586-1670
fax (907) 586-3612
ktoo@juneau.com
www.ktoo.org

GRAPHIC DESIGN

Alaska Litho

8420 Airport Boulevard
Juneau, AK 99801
tel. (907) 586-3170
fax (907) 463-4924
travis@aklitho.com
www.aklitho.com

Copy Express

230 Seward Street
Juneau, AK 99801
tel. (907) 586-2174
fax (907) 463-3083
ken@copy-express.com
www.copy-express.com

Printing Trade Company

10002 Crazy Horse Drive
Juneau, AK 99801
tel. (907) 789-7636
fax (907) 789-9472
ptc@alaska.com

Sarahgraphics Graphic Design & Illustration

4600 Glacier Highway
Juneau, AK 99801
tel. (907) 780-6108
sarah@gci.net

WHY NOT STAY A LITTLE BIT LONGER?

Why not extend your stay and take advantage of all the fun and excitement Alaska's capital city has to offer?

Juneau is home to Alaska's most accessible glaciers.

You can fly over them, hike around them, land on them in a helicopter, trek over them or go to the Mendenhall Glacier Visitors Center and just gaze in wonderment.

Juneau has over 90 trails – Why not plan to hike a few? The Tongass National Forest is a hiker's paradise.

Like to fish? You can catch salmon, halibut or a host of other interesting species. Ever tried flyfishing in the wilderness? Take a float plane trip to an unspoiled spot and cast your line under the watchful eye of an experienced guide.

When was the last time you saw a humpback whale breach? Take a whale watching trip and be thrilled by these awe-inspiring mammals. Juneau has one of the largest populations of whales in the state.

Or take a whole day for a boat trip into spectacular Tracy Arm fjord. Whales, eagles, orcas, seals, sea lions, and a spectacular glacier are the ingredients for a trip you will never forget.

If you are here during the winter, you can enjoy downhill or cross-country skiing at Juneau's Eaglecrest Ski Area.



ALASKA AIRLINES



Juneau is just a flight away with Alaska Airlines daily nonstop jet service from Seattle or Anchorage. If you're traveling from the East Coast, Midwest or South, choose one of Alaska Airlines new daily nonstop flights from Washington D.C., Newark, Boston, Orlando, Miami, Chicago, Denver or Dallas. And, if business or pleasure takes you to other Alaska destinations, Alaska Airlines also offers service from Juneau to eighteen other Alaska destinations.

To reach us call one of the following toll-free numbers or find us on the internet.

Alaska Airlines

(800) ALASKAAIR (800 252-7522)

Group Desk: (800) 445-4435

Mileage Plan: (800)-654-5664

www.alaskaair.com

WHAT TO WEAR:

Juneauites dress for the weather at hand. Casual, comfortable clothing and shoes are appropriate for most occasions. Summer wear could include shorts and sandals, but always be prepared for precipitation (Juneau is in a rainforest). Recommended winter wear includes warm coats, rain jackets/ponchos, boots, hats and gloves. Dressing in layers and having a fleece jacket, especially if you are venturing out, is recommended all year.

Taxes:

City Sales tax 5%
Local Bed Tax 7%

Currency:

US Dollar

Mar. temp. 39°-27°
rain 3.28"
daylight 11.77 hrs.

Apr. temp. 47°-32°
rain 2.77"
daylight 14.40 hrs.

Feb. temp 34°-23°
rain 3.75"
daylight 9.40 hrs.

May temp. 55°-39°
rain 3.42"
daylight 16.78 hrs.

Jan. temp. 29°-19°
rain 4.54"
daylight 7.15 hrs.

June temp. 61°-45°
rain 3.15"
daylight 18.25 hrs.

Dec. temp 32°-23°
rain 4.44"
daylight 6.42 hrs.

July temp. 64°- 48°
rain 4.16"
daylight 17.60 hrs.

Nov. temp. 37°-27°
rain 4.91"
daylight 7.87 hrs.

Aug. temp. 63°-47°
rain 5.32"
daylight 15.43 hrs.

Oct. temp. 47°-37°
rain 7.84"
daylight 10.32 hrs.

Sept. temp. 56°-43°
rain 6.73"
daylight 12.85 hrs.

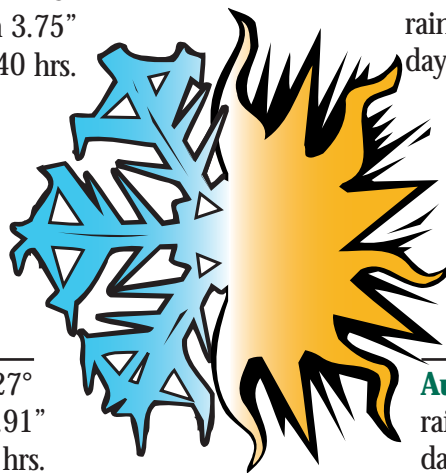

Local time, temperature and forecast:

Time & Temperature: (907) 586-3185
Forecast: (907) 586-3997

FUN THINGS TO DO IN JUNEAU:

- Museums
- Whale Watching
- Gold Panning
- Camping
- River Rafting
- Berry Picking
- Self-Guided Tours
- Local Nightlife
- Alaskan Brewery Tours
- Mendenhall Glacier Visitors Center Exhibits
- "First Fridays" Gallery Walks
- Alaska Folk Festival (April)
- Wearable Art Extravaganza

- Perseverance Theatre
- Juneau Jazz & Classics
- Concerts in the Park
- Juneau Symphony
- Holiday High Teas
- Governor's Open House
- Juneau Public Market
- Flightseeing
- Ice Skating
- Dog Sledding
- Downhill/Cross-Country Skiing
- Snowboarding
- Snow Tubing
- Snowshoeing

- Hiking, Biking
- Fishing
- Golfing
- Bird Watching
- Kayaking
- Concerts
- Films
- Live Theater
- Art Exhibits
- Local Arts & Crafts

the list goes on and on



JUNEAU CONVENTION & VISITORS BUREAU
101 EGAN DRIVE, JUNEAU, AK 99801

TOLL FREE 1-800-587-2201

TEL. (907) 586-1737 FAX (907) 586-1449

WEB SITE: www.traveljuneau.com

EMAIL: meetinginfo@traveljuneau.com

PRSRRT STD
U.S. Postage
PAID
Juneau CVB

